



MACHINERY DIVISION

6465 18 MILE ROAD
STERLING HEIGHTS, MI 48314

PHONE:
(586) 731-3600 • 1-800-860-1740

FAX:
(586) 731-7464 • 1-800-862-1740

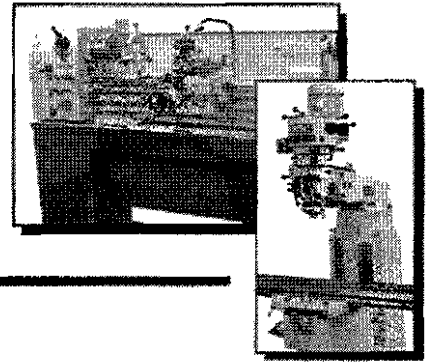

MODEL DS-20 SANDER

THANK YOU FOR PURCHASING WITH KBC MACHINERY. ALL KBC MACHINES ARE BACKED BY OUR 1 YEAR PARTS REPLACEMENT WARRANTY. WHEN USED AS INTENDED, AND WITH PROPER MAINTENANCE THIS MACHINE WILL PROVIDE YOU WITH YEARS OF TROUBLE-FREE SERVICE. IF YOU NEED PARTS SIMPLY FILL OUT THE PARTS REQUEST FORM, AND FAX OR E-MAIL YOUR REQUEST. ALL OTHER QUESTIONS PLEASE CONTACT US @ :

**KBC MACHINERY
6465 18 MILE ROAD
STERLING HEIGHTS, MI 48314
PH (800) 860-1740
FAX (800) 862-1740
MACHINERY@KBCTOOLS.COM
WWW.KBCTOOLSANDMACHINERY.COM**



PARTS REQUEST FORM

YOUR COMPANY NAME: _____

STATE/PROVINCE _____

YOUR NAME _____

PHONE # + EXT _____

FAX # _____

MACHINE INFO: _____

MAKE/MANUFACTURER _____

MODEL NUMBER _____

YEAR MADE _____

SERIAL# _____

PARTS REQUESTED:

PART#	DESCRIPTION
-------	-------------

_____	_____
-------	-------

_____	_____
-------	-------

_____	_____
-------	-------

_____	_____
-------	-------

_____	_____
-------	-------

_____	_____
-------	-------

_____	_____
-------	-------

PLEASE INCLUDE COPY(S) OF THE PARTS DRAWING FROM THE
MANUAL AND CIRCLE THE PARTS NEEDED

FAX PARTS REQUEST TO (800) 862-1740

E-MAIL PARTS REQUEST TO: machinery@kbctools.com

THANKS; KBC MACHINERY - MICHIGAN

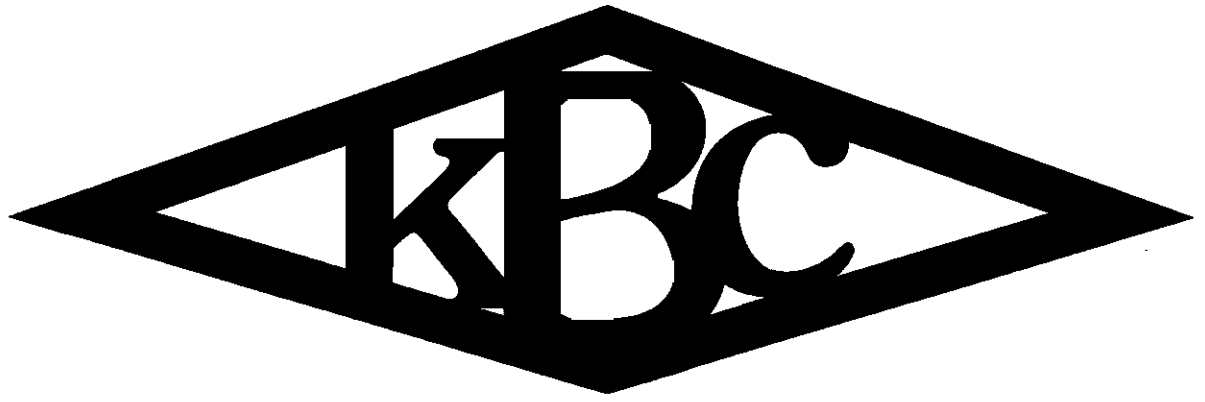

machinery

20" DISC SANDER GRINDER

DS-20



20" DISC SANDER GRINDER

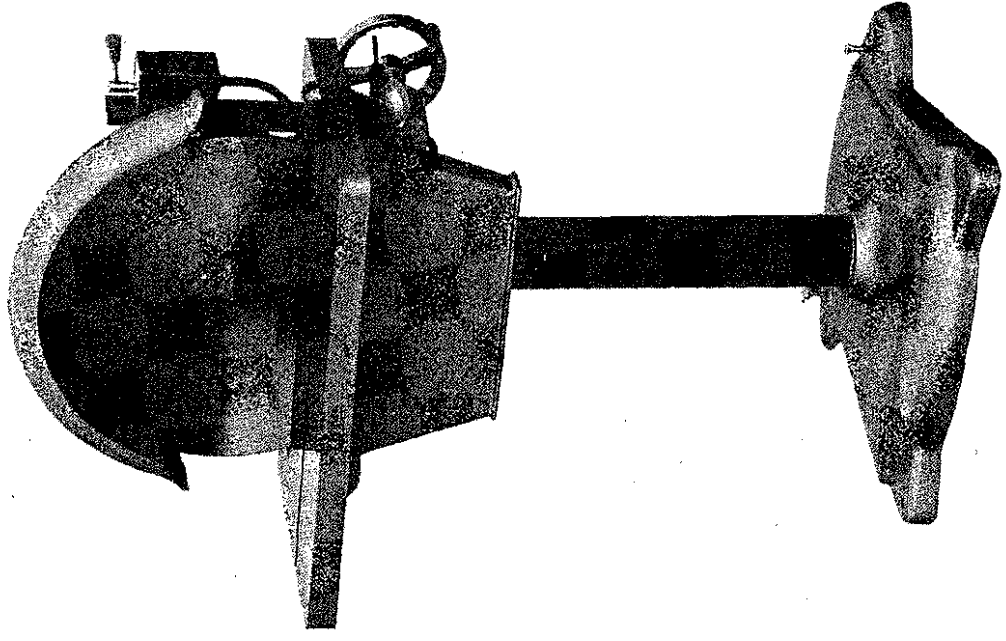

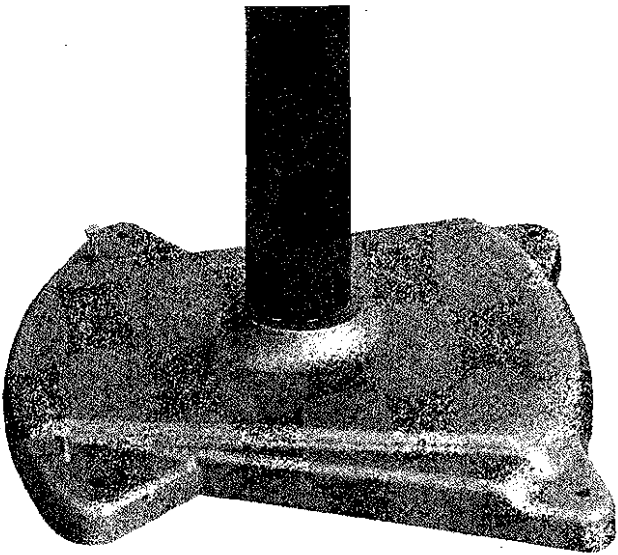

BASE

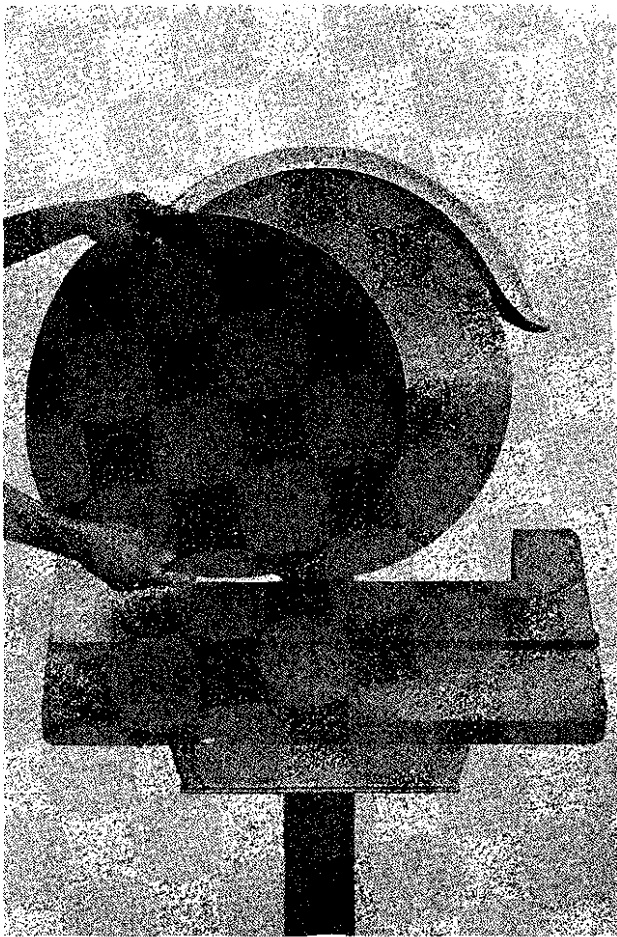

The table can be tilted 45° degrees to the right and 15° degrees to the left.

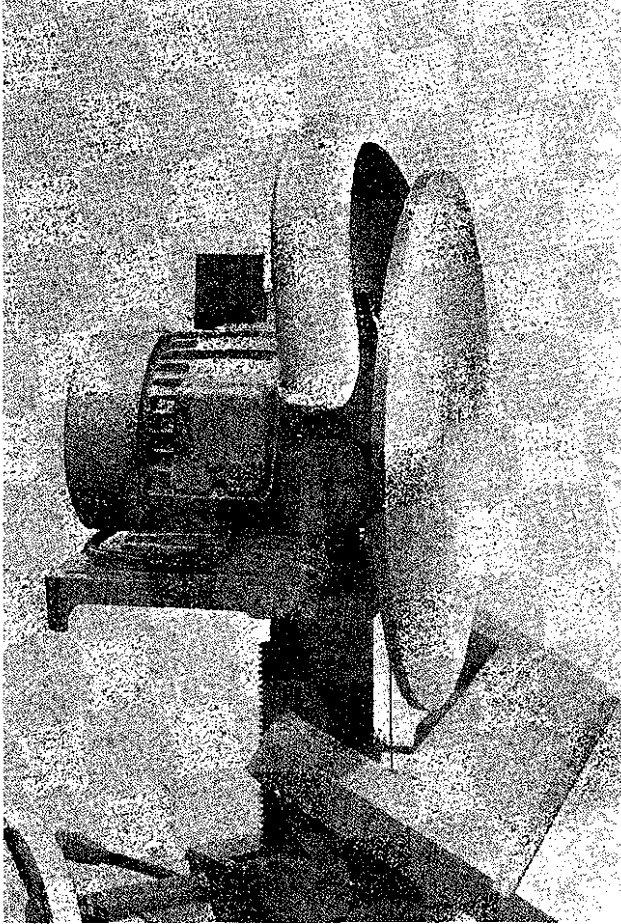

Before changing the DISC, adjusting lower the working table.

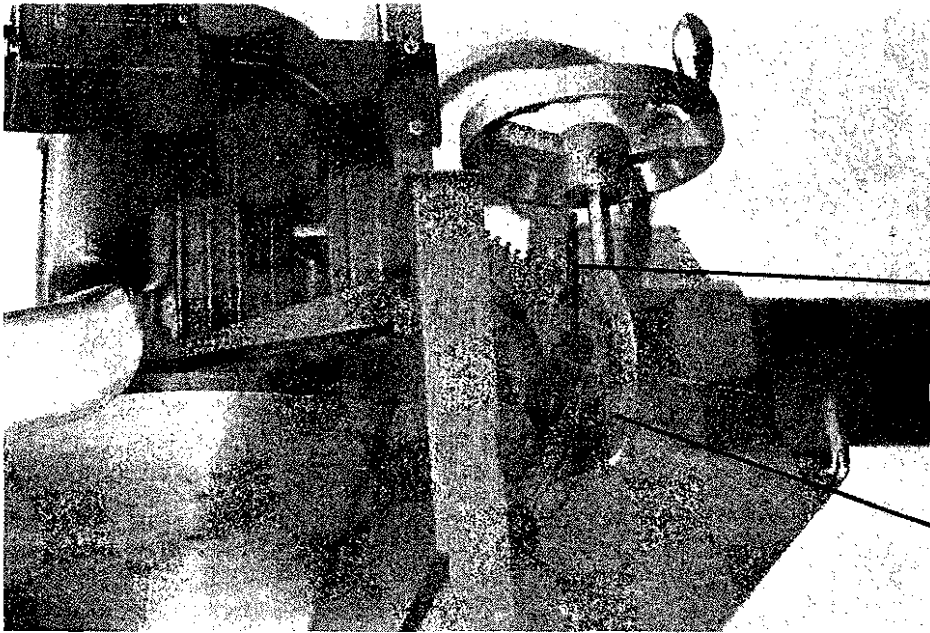

(A) To tilt the table, loosen the knob, after finished tighten it.

(B) Mitre Gauge

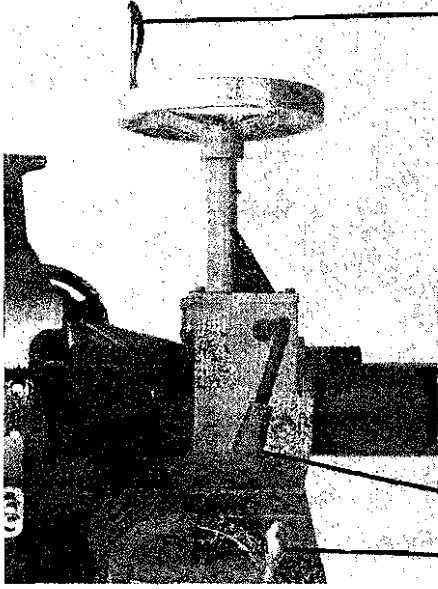

(B) To adjusting the table, loosen this knob, after finished tighten it.

(A) Knob of tilting the table (Table can be tilted 45° degrees to the right and 15° degrees to the left)

(C) Knob of adjusting the working table upper or lower

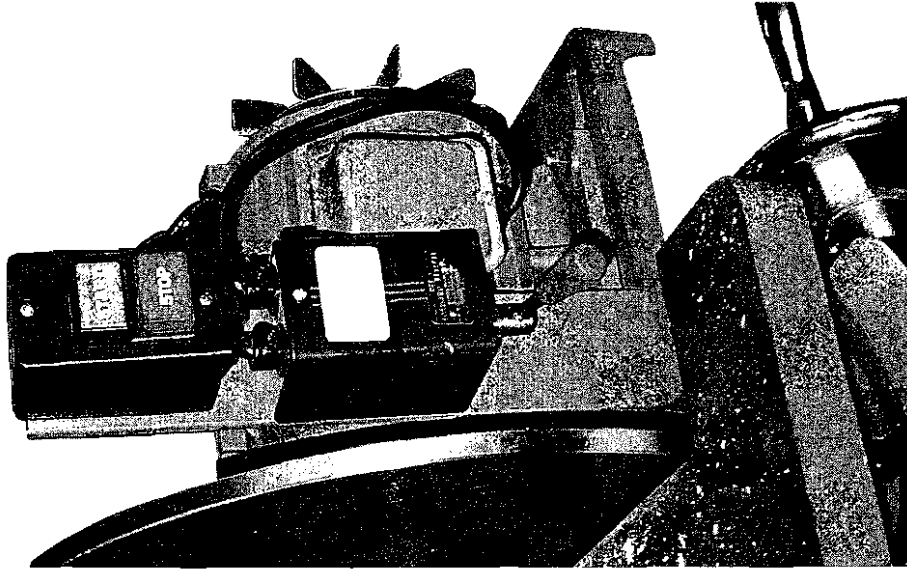

ON/OFF AND FORWARD-BACKWARD SWITCH

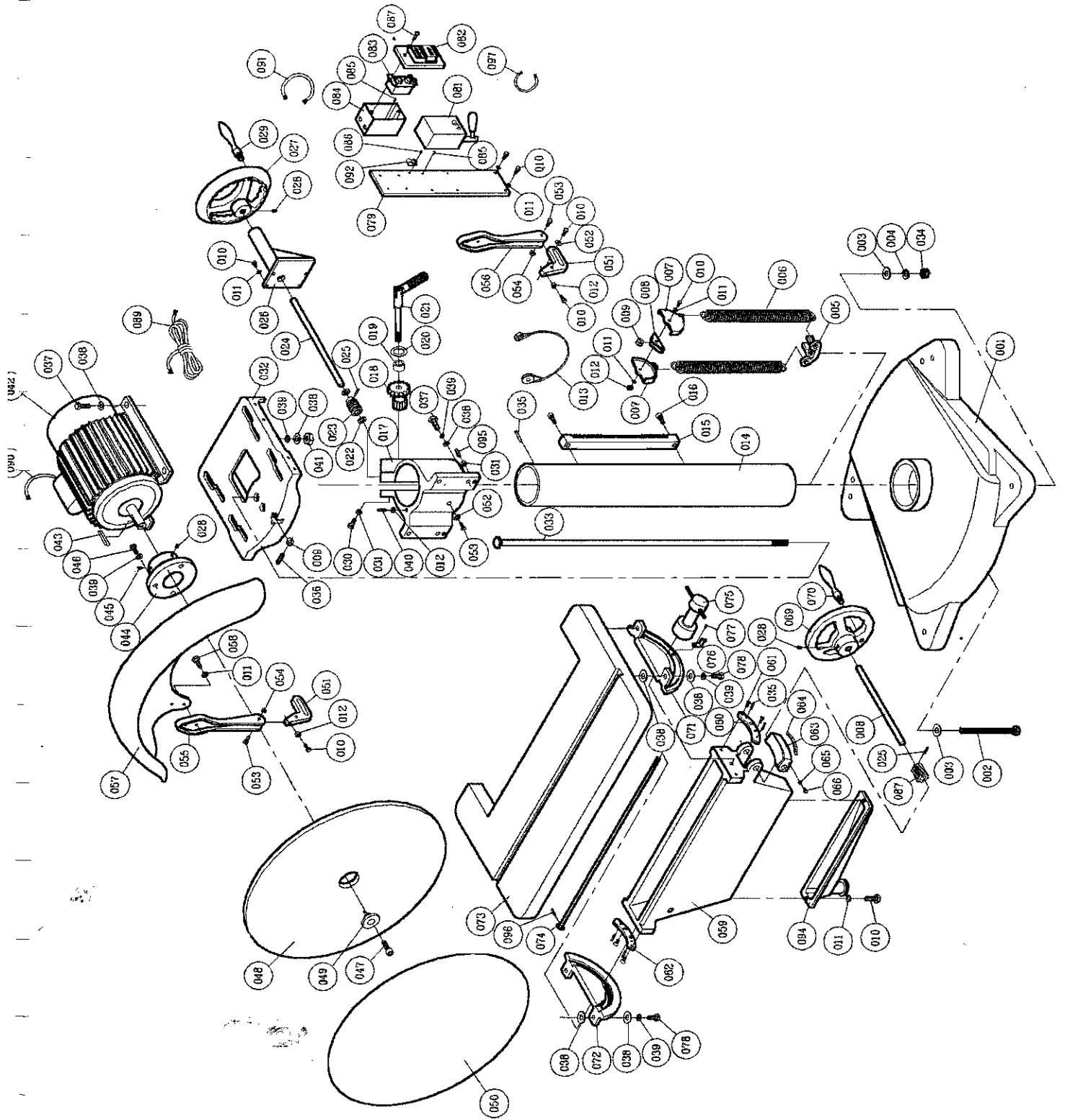

PART NO.	DESCRIPTION	Q'TY	SPE	NO.	PART NO.	DESCRIPTION	Q'TY	SPE	NO.	PART NO.	DESCRIPTION	Q'TY	SPE
38011001	Base	1		041	50251006	HEX.nut	5	3/8-16unc	082	38011063	Switch face plate	1	
38011002	Spring stud bolt	1		042	38011026	Motor	1		083	38011065	On/Off switch	1	
50351015	Flat washer	2	D1/2"*32*3t,鍍鋅	043	50604021	Key	1	7*7*30L	084	38011067	On/off switch cover	1	
50352014	Spring washer	1	1/2"	044	38011027	Hub	1		085	50154014	Round head screw	8	1/4"*20unc*3/8"L
38011003	Bracket	1		045	50153008	SET screw	2	5/16"*18UNC*1/2"L	086	50154022	Round head screw	1	3/16"*24unc*3/8"L
38011004	Spring	2		046	50151029	HEX. screw	3	3/8"*16UNC*1-1/4"L	087	50154023	Round head screw	2	3/16"*24unc*3/4"L
38011005	Keeper	2		047	50152003	CAP screw	1	1/4"*20unc*3/4"L	089	38011051	Power cord	1	
38011006	Sheeve stand	1		048	38011028	Disc	1		090	38011055	Motor cord	1	
38011007	Sheeve	2		049	38011029	Clamp block	1		091	38011058	Switch cord	1	
50151068	Fixed screw		1/4*20unc*1"L	050	38011030	Sanding cloth	1	#100	092	51105001	Wire clip	1	
50302002	Fixed washer	16	1/4"	050-1	38011093	Sanding cloth	1	#80	093	51102003	Wire protector	2	
50251001	HEX.nut	5	1/4*20unc	050-2	38011094	Sanding cloth	1	#60	094	38011079	Dust chute	1	Optional
38011102	Wire set	1		051	38011031	Guard bracket	2		095	50153026	SET screw	2	5/16"-18UNC*1-1/4"
38011008	Wire	1		052	50351002	Flat washer	9	d1/4"*d13*1t	096	50602028	Spring pin	1	3*16L
38011062	Sheave	1		053	50151070	Hex.screw	3	1/4"*20unc*1-1/2"L	097	38011080	Wire ,switch	1	2.0*5CM*2Y
38011009	Column	1		054	50252006	Nylon nut	2	1/4"*20unc					
38011010	Rack	1		055	38011032	L. H guard arm	1						
50152023	CAP screw	2	5/16"*18UNC*1/2"L	056	38011033	R.H guard arm	1						
38011011	Cover& support	1		057	38011034	Disc guard	1						
38011012	Worm gear	1		058	50151064	Hex. screw	4	1/4"*20unc*5/8"L					
38011013	Washer	1		059	38011035	Solid segment	1						
50301019	Fixed washer	1	ID13*OD28.4*1.5t	060	38011036	Pilot right	1						
38011101	Up&Down handleset	1		061	50155005	PLP head screw	4	1/4"*20unc*1/2"L					
38011016	Washer	2		062	38011037	Pilot left	1						
38011017	Worm,table lifting	1		063	38011038	Scale indicator	1						
38011018	Shaft	1		064	38011039	protractor	1						
50602019	Spring pin	3	D4*20L	065	50251017	Hex.nut	3	3/16"*24unc					
38011019	Shaft base	1		066	50151063	Hex.screw	1	3/16"*24unc*3/4"L					
38011020	Handle wheel	1		067	38011040	Worm,table tilt	1						
50153009	SET screw-	3	5/16"*18unc*3/4"L	068	38011041	shaft	1						
38011021	Handle	2		069	38011042	Pointer/wheel	1						
50151056	HEX.screw	1	5/16"*18unc*1-3/4"L	070	38011025	Knob	1						
50251003	HEX. nut	1	5/16"-18unc	071	38011043	Gear segment	1						
38011022	Motor mount	1		072	38011044	Table fixer	1						
38011023	Stud bolt	1		073	38011045	Table	1						
50251008	HEX. nut	1	1/2"*12UNC	074	38011046	Fixed pin	1						
50602007	Spring pin	5	D5*20L	075	38011047	Scale set knob	1						
38011024	Piu , wheel	1		076	38011048	Scale indicator	1						
50151034	HEX. nut	4	3/8"*16UNC*1-3/4"L	077	50104001	Round head screw	1	M4*0.7p*6L					
50301038	Flat washer	20	d10*23*2t	078	50151019	Hex. screw	4	3/8"*16unc*1"L					
50352004	Spring washer	15	3/8"	079	38011049	Switch plate	1						
50153027	Set. screw	4	1/4"-20UNC*1"L	081	38011050	Switch control	1						

Foot Brake Device (Optional)

001	38013001	Foot Pedal	1
002	38013002	Padal base	1
003	50301043	Fiat washer	4
004	50152021	Cap screw	2
005	50251001	Hex. Nut	1
006	50152031	CAP screw	1
007	50152030	CAP screw	1
008	50252001	Nylon nut	1
009	38013003	Spring	1
010	38013012	Bolt	1
011	38013004	Connector	1
012	50152002	CAP screw	1
013	38013005	Spring	1
014	38013006	Draw bar	1
015	38013007	Center rod	1
016	38013010	Brake wire	1
017	38013009	Stop	1
019	38013011	Wire clip	1
020	50152039	Wire	1
021	50252003	Hex. nut	1
022	38011027	Adapter	1
023	38012101	Miter gauge assembly	1
			Optional

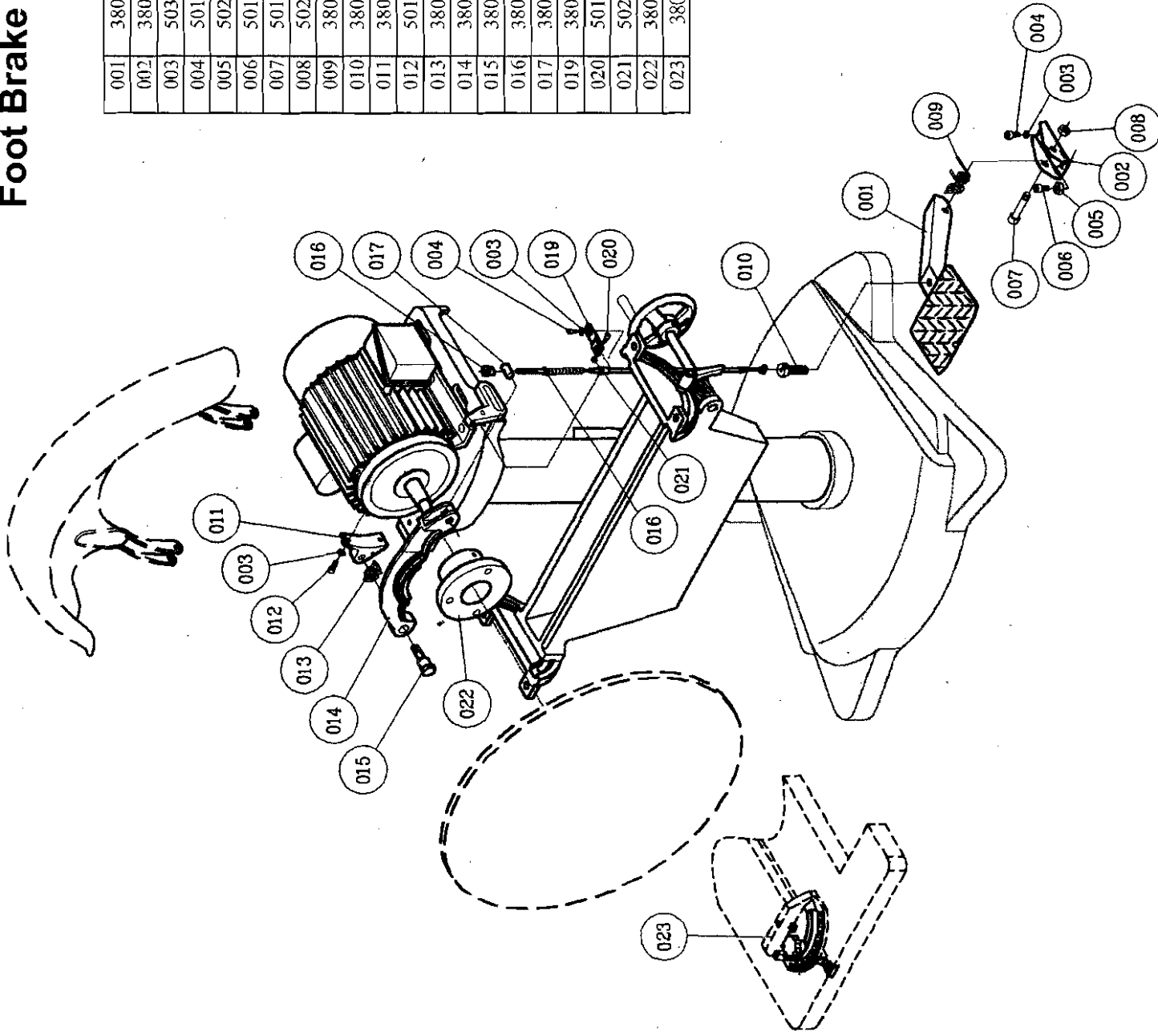

WARNING

- Installation, operation, and maintenance of your sander must be done in accordance with all codes and acts for your personal safety. Trained and experienced equipment installers should install the machine.
- Keep the floor area around the machine clean and free of chips, liquids, stock material or anything else that may prevent the operator from using the machine safely.
- Disconnect machine from electrical power before performing any maintenance.
- Check that the power switch is in the OFF position before connecting machine to power.
- Give your work your full attention. Horseplay, looking around, and carrying on a conversation while using the machine are careless acts that can result in serious injury.
- Keep this manual and all maintenance records handy for operators and maintenance technicians.
- Remove adjusting keys and wrenches after making adjustments.
- Avoid working in a dangerous environment. Don't use power tools in damp or wet locations or expose them to rain. Work only in a well lit area.
- Don't force tool. It will do the job better and safer at the rate for which it was designed.
- Wear proper apparel. Do not wear loose clothing, gloves, neckties, or jewelry as they may get caught in moving parts. Non-slip footwear is recommended. Wear protective hair covering to contain long hair.
- Use safety glasses. Also, use face or dust masks if cutting operation is dusty. If eyeglasses only have impact resistant lenses, they are not safety glasses.
- Stop machine to remove chips and scrap.
- Disconnect tools before servicing and when changing accessories such as sanding cloth.
- Don't operate tool while under the influence of drugs, alcohol, medication or fatigued.
- Never leave a tool running unattended. Turn power off and don't leave tool until it comes to a complete stop.